

JU series Jumper Wire

◆ Features

- » Inability to connect two points on a P.C. Board due to other circuit paths which must be crossed over
 - » An After-the Fact design change that requires new point connections
 - » Circuit tuning by changing point connections
 - » Jumper wires offer a quick simple solution to these problems.
- They are especially suited for automatic machine insertion on lead tape or available in all package styles including precut and formed leads for manual insertion

◆ Power Ratings Dimensions

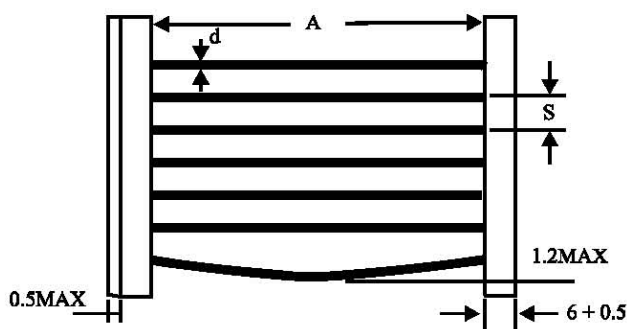

◆ Dimensions

Type	Dimensions (mm)				Current Rating
	A	S	d		
JU05	52.4±1	26 +1 -0	5±0.2	0.5±0.05	6 AMPS at 70°C
JU06	52.4±1	26 +1 -0	5±0.2	0.6±0.05	7.5 AMPS at 70°C
JU07	52.4±1	26 +1 -0	5±0.2	0.7±0.05	8.5 AMPS at 70°C
JU08	52.4±1	26 +1 -0	5±0.2	0.8±0.05	10 AMPS at 70°C
JU10	52.4±1	26 +1 -0	5±0.2	1.0±0.05	10 AMPS at 70°C

Material of Jumper Wire	Soft Copper with tin plating
Conductor Resistance	0.54mΩ/cm
Wire Diameter	±0.03%
Tension Strength	CNS 656 24kgs ±4kg/mm ²
Extension Rate	CNS 656 28% ±2%
Conductivity	Minimum 96%
Twisting Strength	CNS 360°C → 2cycles
Solder ability	JIS-5012-C5033 260°C ± 5°C, 3 sec. Coverage 95%
Element of Plating	Tin 99~100% Lead 0-1%(or depend on customer requirement)
Thickness of Plating	5u±2u
Appearance	Smooth and shining

◆ Special Forming Dimension

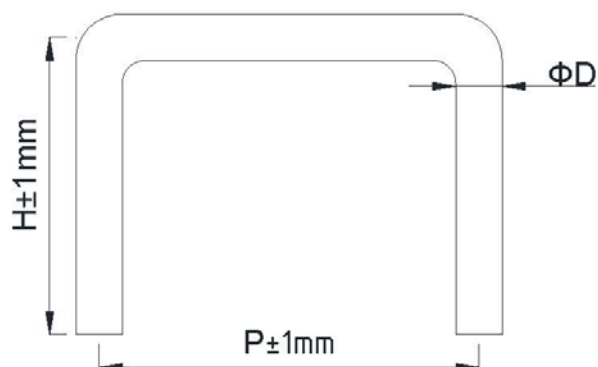

DΦ	0.45	0.5	0.55	0.58	0.65	0.7	0.78
P	4	Adjustable (mm)2.5mm~20mm					
H	8	Fixed Height is 8mm					

◆ Part Number

JU	0.6	52	T
Type	Diameter	Dimension	Packing
Jumper Wire	0.5	52=52mm	T = Taping Box
	0.6	26=26mm	B = Bulk
	0.7	8x5 = HxP	R = Taping Reel
	0.8		
	1.0		